

Operation and maintenance manual

Red 5 hoof trimming chute

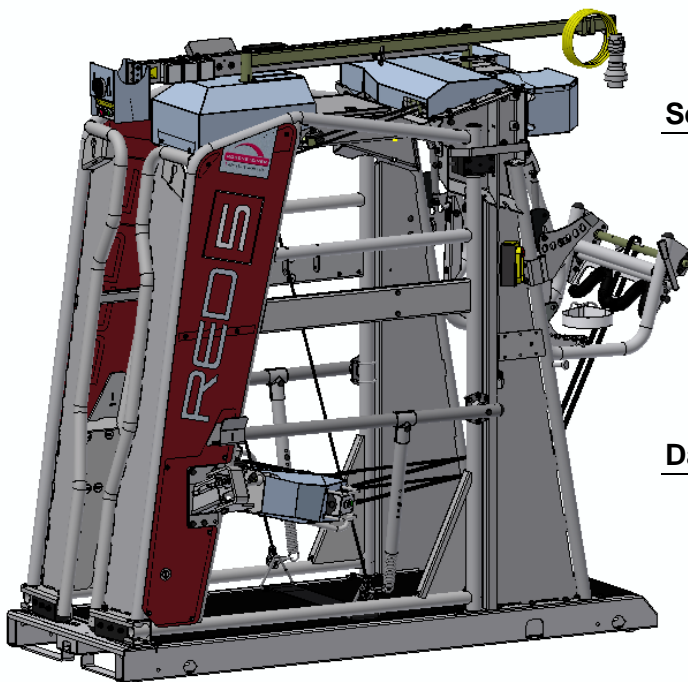

Red 5 – Basic
Red 5 – Comfort
Red 5 – Professional



Serial number: _____

Date of purchase: _____

Read this manual before commissioning.
Retain this manual for future reference.
Stand: 03/2024

Contents

1	INTRODUCTION.....	3
1.1	Product information	3
1.2	Intended use.....	4
1.3	Examples of improper use	4
1.4	Information on reducing noise and vibrations	4
1.5	EC Declaration of Conformity.....	5
1.6	Warranty Statement	5
1.7	Specifications.....	6
1.8	Type plate.....	6
1.9	Operating manual structure and scope.....	6
1.9.1	Document structure	6
1.9.2	Target group	6
1.9.3	Modifications on the operation manual.....	7
1.9.4	How to store this operation manual	7
1.9.5	Space limitations.....	7
1.9.6	Time limitations	7
1.9.7	Working place for the hoof trimming chute	7
1.9.8	Erklärung der Informations- und Gefahrenhinweise	8
1.9.9	Operating manual and machine safety symbols	8
2	TRANSPORT	9
2.1	Transport with tractor on three-point linkage	9
2.1.1	Mounting the hoof trimming chute to a tractor	9
2.1.2	Moving the hoof trimming chute with a tractor	10
2.1.3	Detach the hoof trimming chute from the tractor and park it	11
2.2	Transport with hand transport device	11
2.3	Transport with pallet truck	11
3	INSTALLATION / OPERATION	12
3.1	Device overview / main controls	12
3.2	Safety advice before Installation	14
3.3	Operating the hoof trimming chute	15
3.4	Procedure in case of electrical power failure or malfunction	18
3.5	Animal welfare and natural motion sequences.....	20
4	CLEANING.....	20
5	MAINTENANCE / SERVICING / REPAIR	21
5.1	Electrical danger	21
5.2	Maintenance and care	22
6	SPARE PARTS	23
7	PERIODIC INSPECTION	23
8	SCOPE OF DELIVERY / ACCESSORIES	23

1 Introduction

1.1 Product information

Your new Rosensteiner RED 5 hoof trimming chute is a quality product featuring innovative technology for animal hoof care. This hoof trimming chute is intended to be used for periodic, qualified, efficient hoof care while enabling the user to assume ergonomic, appropriate, non-fatigue posture.

For this manual, this hoof trimming chute will also be referred to as the 'product.'



At the time of marketing, this product and its equipment represent state-of-the-art technology. However, certain residual risks do remain. We have designed the product to minimise any user-related health or safety risks which may be caused by such hazards.

This document contains important information on both the safe use of this product and all required activities such as operation, maintenance or repair work. By following all relevant instructions, you will help avoid any hazards and increase the service life of the product. You are not permitted to modify the product in any way.

The documentation provided by our suppliers and, most importantly, the information and instructions contained therein are fully applicable and should also be followed.

The manufacturer accepts no liability for damage caused by inappropriate action or by failure to follow the information or instructions as mentioned in the manuals.

While we have taken utmost care to make sure the information within this manual is correct and up to date, there may be minor discrepancies with regard to its contents. Please advise us of any such errors.

CAUTION



The manufacturer accepts no liability for any unauthorised (constructional, functional or process-related) modifications or any use of parts or attachments on the product.

WARNING



Any modifications or alterations made to the product described in this document require a new hazard analysis and risk evaluation to be performed. The genuine parts and accessories we offer have been specifically designed for this product. Please note that any parts or accessories not provided and/or specified by us have not been tested nor approved by us. Installing and/or using such parts or accessories may negatively affect or restrict the functionalities this product was originally designed for. The manufacturer accepts no liability for damage arising from the use of any non-genuine parts or accessories.

1.2 Intended use

The RED 5 hoof trimming chute is solely intended for hoof care work performed on animal hoofs.

This hoof trimming chute is suitable for cattle weight from 450 kg up to a maximum of 1000 kg.

Any activities contrary to the product's intended use are considered improper and, as such, not permitted. This also applies to the product's components.

1.3 Examples of improper use

- Any operation or use contrary to or going beyond the product's intended use.
- Any use of the product contrary to the safety and hazard requirements or any other instructions contained in the operating manual. This also applies to errors caused by poorly executed, improper or unauthorised work performed on the product or while using the product.
- Any modification, by-passing or decommissioning of any product devices ensuring the product's correct operation or contributing to active or passive user safety.
- Operating the product in a technically incorrect state.
- Failure to amend faults affecting user safety before operating the product.
- Use of non-permitted auxiliary equipment or tools.

The manufacturer accepts no liability for any damage caused by improper use of the product!

1.4 Information on reducing noise and vibrations

The maximum emission sound pressure level occurring at the machine is 71 dB(A).

In general, ear protection is recommended, especially when claw care is carried out with disc grinders.

To reduce vibrations, place the hoof trimming chute on a level surface and, if possible, also mount it on the ground (for example with the help of concrete anchors).

1.5 EC Declaration of Conformity

Manufacturer and responsible for documentation::

ROSENSTEINER GmbH
Hermesstraße 2b
A-4595 Waldneukirchen
Telefon +43(0)7258/20 110

declares that the following product:

Type:	RED 5 Basic RED 5 Comfort RED 5 Professional
Bezeichnung:	Klauenpflegestand RED 5
Fabrikat:	Rosensteiner

as described in the attached operating manual, complies with the provisions set forth in the 2014/35/EU Machinery Directive.



Steinbach, den 30.03.2021



Andreas Rosensteiner, Inhaber

1.6 Warranty Statement

Rosensteiner Landmaschinenbau GmbH grants the purchaser a product warranty in accordance with the following provisions:

- The warranty shall cover the product's functionality and quality. No warranty is granted for signs of wear.
- The warranty period is 2 years, beginning at the date of delivery to the customer. The manufacturer considers any warranty claims received by the dealership or by our factory (Hermesstraße 2b, A-4595 Waldneukirchen, Austria) within the warranty period.
- If within the warranty period the product suffers any defects in material or workmanship, the customer shall immediately assert the relevant warranty claims with their dealership or manufacturer.
- The customer shall present the defective device or part to the dealership. Any subsequent repair or replacement work may not be performed without the approval from Rosensteiner. The manufacturer will not incur any expenditure without their express consent. Any defective parts shall be stored at the dealership or sent to Rosensteiner as agreed: The customer has to bring the device to the dealer freight paid.
- Warranty claims cannot be accepted if the device is damaged or destroyed by force majeure. Caution: Please note that warranty claims are not accepted for damage caused by improper use, overload, attaching the product to carrier vehicles of disproportionate size, or failure caused by not paying attention to maintenance work!
- Warranty can just be accepted when the device is presented along with the purchase contract, invoice or delivery note as well as the device serial number.
- The warranty is performed in a way that the device is repaired or replaced by a functional equivalent.

- Any further claims, particularly damage or loss caused by the regular use and/or operation of the devices are not accepted.
- Provided that we replace the device or product in question under this warranty, any warranty claims against the selling dealership are not excluded.

1.7 Specifications

Machine Type	RED 5 hoof trimming chute
Dimensions	2450(2300)/1220/2200 (L/W/H)
Recommended animal weight	450-1000 kg
Product weight	625-725 kg
Attachment	pallet truck, forklift truck (both sides) preparation for manual transport devices preparation for 3-point linkage
Frame surface	galvanised, powder-coated

1.8 Type plate

The type plate is attached on the left side of the head catching wing.



1.9 Operating manual structure and scope

1.9.1 Document structure

This operating manual was created in accordance with the 2014/35/EU Machinery Directive and the relevant MSV 2010 machine safety regulation applicable in Austria. This operation manual will help you become familiar with the product's technical details, enabling you to properly operate and maintain the product in a safe way and make use of its intended applications.

1.9.2 Target group

The operation manual is intended for people who are familiar with the handling of a hoof trimming chute, with the commissioning and operation of such and have the appropriate qualifications for their activities and functions, i.e. who, based on their technical training, their knowledge and experience, can assess and evaluate the work identify potential hazards.

Every person who works with this hoof care device must be familiar with the handling of the animals/cattle to be treated.

Every person working with this machine (e. g. operation, servicing, transport) has to:

- Read and understand this operating manual before working on the machine.
- Follow all instructions and safety guidelines contained in the manual.

1.9.3 Modifications on the operation manual

This operation manual represents the design of the product at the time of creating this operating manual.

1.9.4 How to store this operation manual

Always keep this operating manual in the same location where the product is operated. The manual should be accessible any time for any person associated with the work performed using the product. If this manual is lost, please contact your dealership for a replacement manual. If you decide to re-sell your hoof trimming chute, please remember to pass this operating manual on to its new owner. The manual is a legally required component of the machine. This operating manual is ready for download at www.rosensteiner.at.

1.9.5 Space limitations

The product is designed for both stationary and mobile use at various locations.

1.9.6 Time limitations

Due to the mechanical strain acting on the product during use, periodically check the components for reliability, susceptibility to failure and limits of use over the product's service life.

The following phases in service life are not covered in this operating manual:

- Manufacture and transport (to the customer/user)
- Service work on the product and its components as performed in workshops
- Any work requiring the qualification and skill levels of the person performing the work (e. g. welding, electrical work, ...).

1.9.7 Working place for the hoof trimming chute

Recommended space requirements for the Red 5:

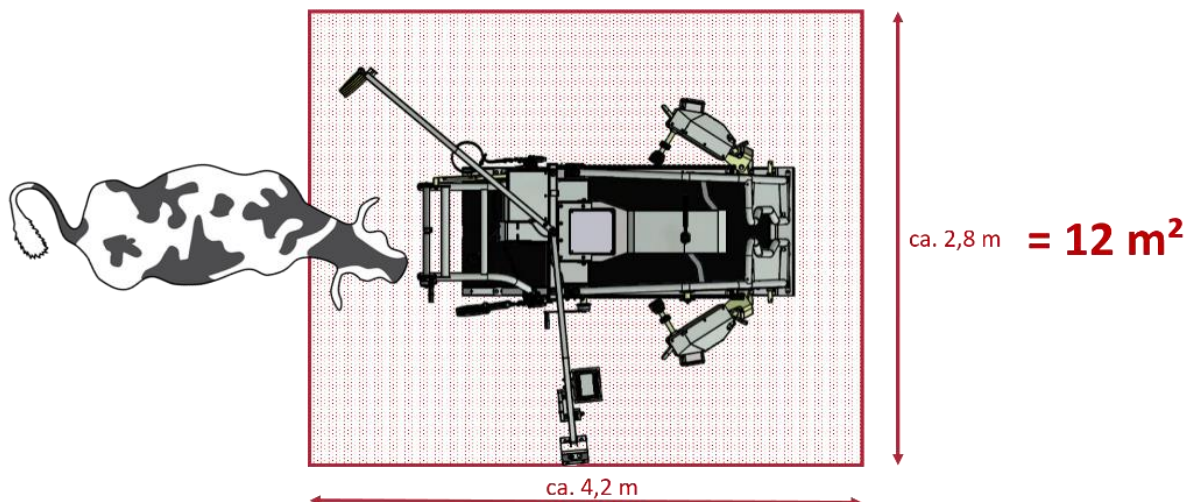

1.9.8 Erklärung der Informations- und Gefahrenhinweise



Any additional information provided in this manual is identified by the above information symbol.

SIGNAL WORD



Identifies the type and source of the hazard and any associated risks.

Potential consequences for people, machine parts, tools and work pieces (residual risk).
Action taken to avoid the danger to life and to reduce any residual risks.

SIGNALWORD

Explanation

NOTE

Indication of a potentially harmful situation which may result in damage to the equipment or nearby property.

CAUTION

Indication of a potentially dangerous situation which may result in minor injury or property damage.

WARNING

Indication of a potentially dangerous situation which may result in major injury or death.

DANGER

Indication of an immediate danger which will result in major injury or death.

1.9.9 Operating manual and machine safety symbols



Never stand between the implement and the tractor.



Crushing hazard!



Read and follow the operating manual and all safety instructions before use!



Stop the engine and disconnect power before performing any repair, maintenance or cleaning work.



Keep a safe distance to high-voltage power lines.!



Before disconnecting or parking the machine use chocks to prevent it from rolling off.



Avoid bumpy terrain or slopes which may cause the device to slip, tip over or overturn.

2 Transport

Three different possibilities are provided for changing the location of this hoof trimming chute. Other variants that deviate from the ones described offer a high potential of danger and are not permitted!

2.1 Transport with tractor on three-point linkage

The following describes the procedure for transporting the hoof trimming chute with a tractor and the risks to be observed.

The three-point hitch on the hoof trimming stand is not fitted as standard.

2.1.1 Mounting the hoof trimming chute to a tractor



To transport the hoof trimming chute with the tractor, the head catch must first be brought into the catching position (power supply necessary!). Lower linkage Cat. II is achieved when the catching doors are almost parallel to the outer bars of the ground.

Then the chute is attached to the lower link of the tractor's hydraulics using the optional lower link pins and to the upper link mount of the tractor using the optional 3-point linkage chain. At least two chain links must hang down inwards on the chain slots in which the chain is suspended on the claw care stand!



WARNING



Reverse the tractor to the chute, making sure that there are no persons in the danger zone between the tractor and the chute!

Take care when mounting:



- Before attaching the hoof trimming chute make sure the front of the tractor is sufficiently ballasted and the parking brake is locked.



- Never step between the tractor and the hoof trimming chute when attaching the product - crushing hazard!
- Use suitable locking pins to mount the hoof trimming chute to the lower links and top-link chain.



- When operating the tractor's hydraulic system (top and lower links), make sure the tractor is stable. Keep a safe distance to any hazardous moving parts. Never step on any parts of the tractor (lower links, ...) or on the hoof trimming chute.
- Never step between the hoof trimming chute and the tractor while the tractor is running.

WARNING



Check transport position:

- The front leg winch must be swung inwards and all safety ropes must be fastened in the bollard clamps..
- The service arm and cable must be brought into the transport position and fixed with the catch at the stop.
- The hind leg retention bracket must be swung to the lowest lockable position.'

2.1.2 Moving the hoof trimming chute with a tractor

WARNING



- When transporting, keep a sufficient distance from electrical high-voltage cable
- When transporting on public roads, observe the road traffic regulations of your country and attach the legally prescribed lights or warning signs to the chute
- Maximum speed when transporting the chute is 25 km/h.



- When driving during the day, two warning plates must be attached to the rear of the chute on the left and right so that the rear lighting of the tractor is not obscured. When driving at night, a lighting strip with complete lighting (lamps on the left and right as on the tractor) must be fitted to the rear of the chute.

2.1.3 Detach the hoof trimming chute from the tractor and park it

To park the hoof trimming chute take care of:

WARNING



- Drive onto a level parking space.



- Secure tractor against rolling (handbrake, brake wedge).



- Lower the hoof trimming chute. When parking the hoof trimming chute, make sure that it cannot tip over or slip, especially if it is placed in an elevated position on stacks, pallets, etc.
- First loosen the upper link chain, then the lower link.

2.2 Transport with hand transport device

The lifting axle incl. the hand transport wheels are not included in the scope of delivery as standard! This variant is used exclusively for establishing the end position of the implement before claw care, not for general transport over longer distances!



- First secure the service arm and cable feed and swing in the front leg winch!
- Engage the ball of the lifting axle in the hole provided and lift the claw care stand with the crank.
- Insert the push-on wheels and turn the lock.
- Place the unit with the wheels back on the ground by pushing the lifting axle towards the unit!
- Place the lifting axle on the opposite side, lift it up and drive.



- **The lifting axle develops a strong pull in the direction of the implement as soon as the lifting axle is pressed above the centre point!**
Hold the axle firmly and support yourself if necessary to avoid injuries!
- **Never place hands and feet under the chute - risk of crushing!**

2.3 Transport with pallet truck

- Serves exclusively to establish the end position of the unit before hoof care and to load the hoof trimming chute.
- Front and rear transport possible
- **Ensure that the forks are sufficiently long and that there is an increased risk of tipping over the chute!**

3 Installation / Operation

3.1 Device overview / main controls

Variant Basic/Comfort:

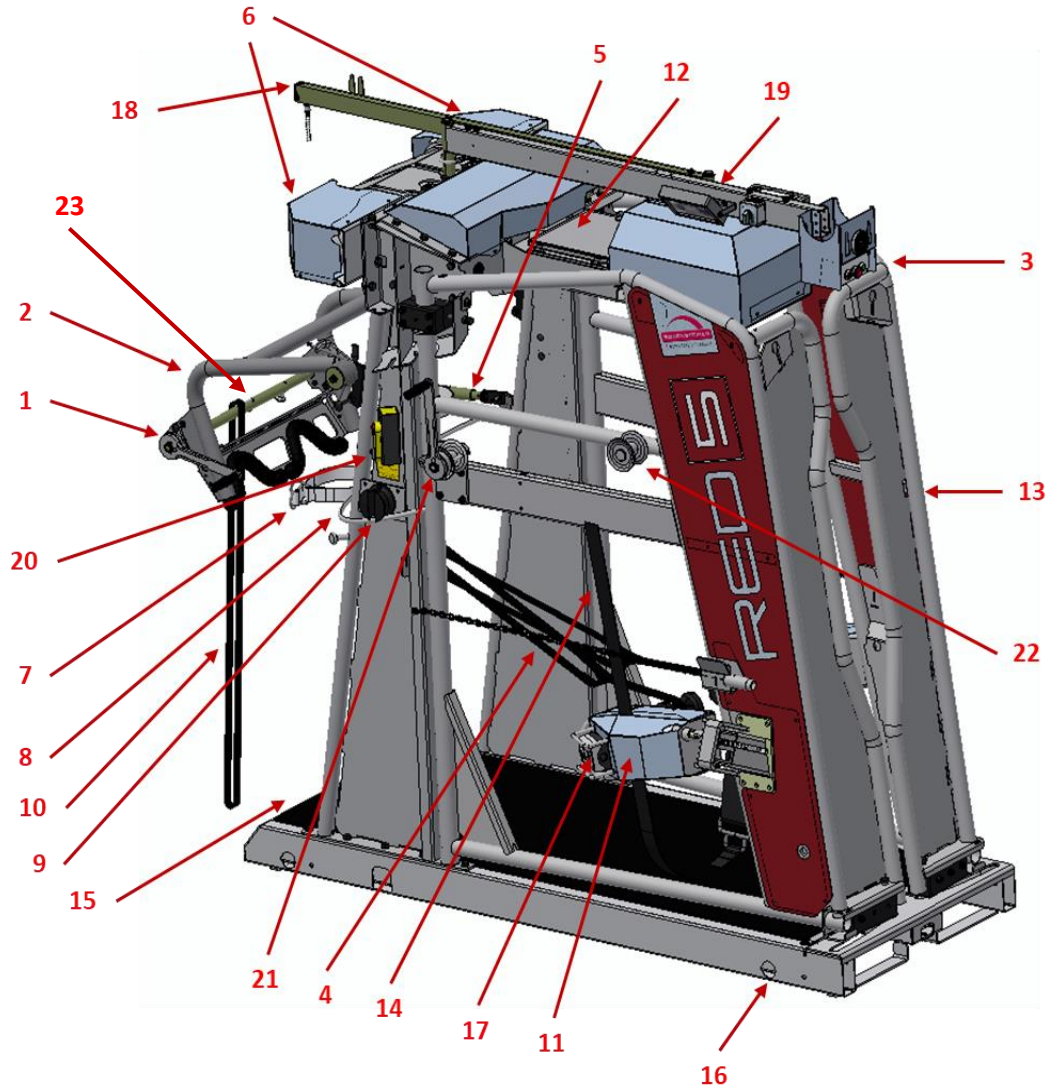

Ref. Description

01	Pressure roller safety crank
03	Head catch control
05	Locking rod
07	Ankle strap
09	Rope clamp
11	Front leg winch
13	Head catch
15	Rubber mat
17	Front leg winch control
21	Pressure roller safety crank
23	Winding shaft

Ref. Description

02	Hind leg retention bracket Basic/Comfort
04	Front foot strap
06	Rear leg winches (1 piece. at Basic)
08	Knee rope
10	Rear foot strap
12	Switchbox
14	Belly strap
16	Mounting holes for hand transport wheels
18	Power connection
20	rear leg winch control
22	Idler pulley

Variant Professional:

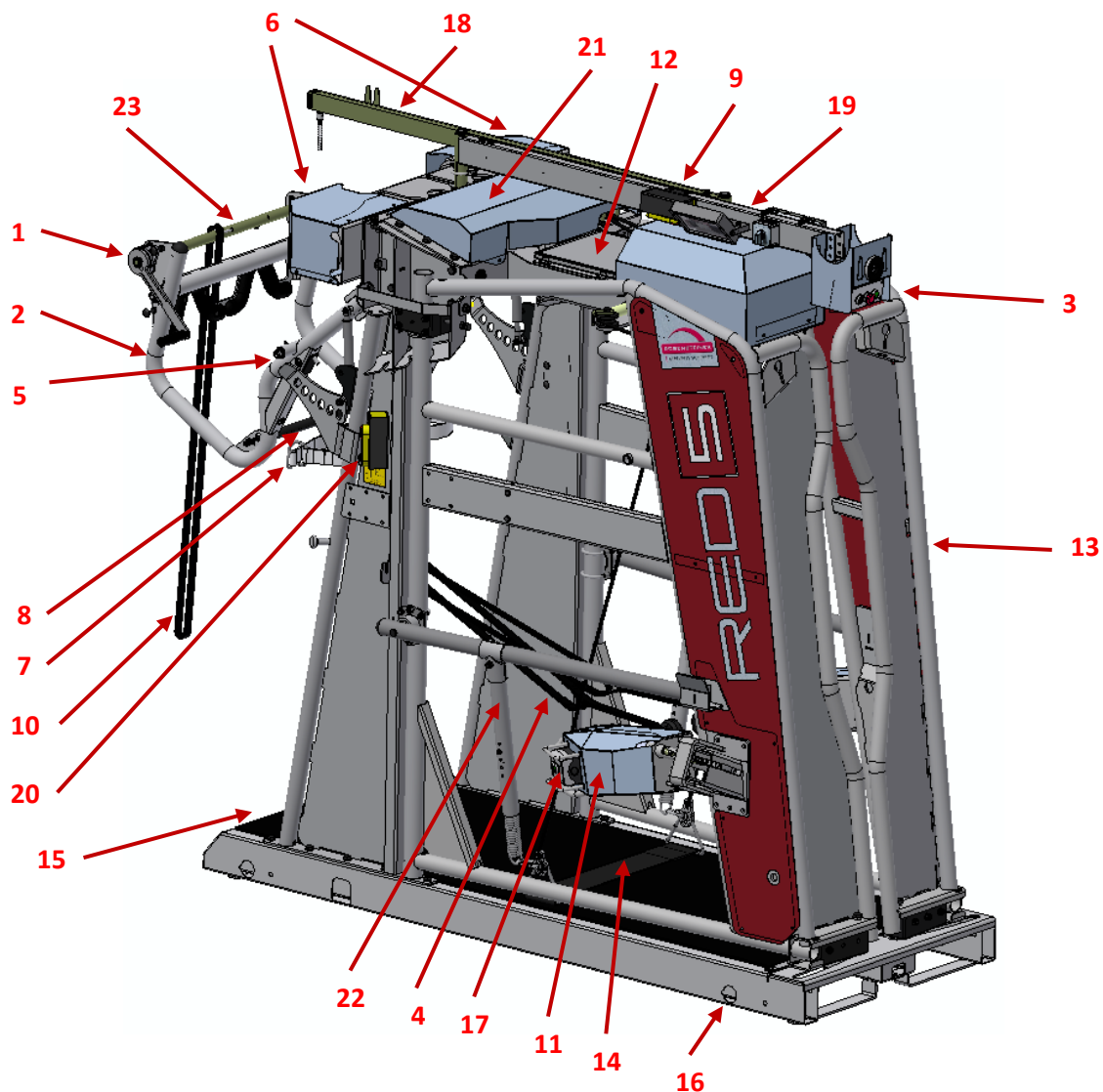

Ref. Description

- 01 Pressure roller safety crank
- 03 Head catch control
- 05 Locking rod
- 07 Ankle strap
- 09 Electr. belly strap control
- 11 Front leg winch
- 13 Head catch
- 15 Rubber mat
- 17 Front leg winch control
- 19 Service arm
- 21 Belly strap winch
- 23 Winding shaft

Ref. Description

- 02 Hind leg retention bracket Professional
- 04 Front foot strap
- 06 Rear leg winches
- 08 Knee chain with protective hose
- 10 Rear foot strap
- 12 Switchbox
- 14 Belly strap
- 16 Mounting holes for hand transport wheels
- 18 Power connection
- 20 Rear leg winch control
- 22 Belly strap arm

3.2 Safety advice before Installation

NOTE



- When installing the product, ask for the assistance of a person experienced in using the hoof trimming chutes.
- Never trim hoofs immediately after feeding the cattle!

WARNING



- Read and follow the instructions in this operating manual before installing and operating the product.
- The product should only be operated by persons familiar with the intended application and the correct handling of cattle.
- Before operation, visually check the hoof trimming chute for any defects.



- Ensure that the hoof trimming chute is placed on an even surface.
- Check the hoof trimming chute for loose bolts or other parts.
- Check belts and ropes for wear.
- Check the condition of all protective devices.
- Check the screw connections and retighten it if necessary.
- The hoof trimming chute may only be operated with suitable protective measures against excessive contact voltage. Earth leakage circuit breaker interrupts at 30mA.
- **The power supply to the chute must contain an electrical neutral conductor. (Sockets and any intermediate cables too)**
- **A maximum total power of 1.9 kW is permitted at the sockets of the service arm (19)! Therefore, pay attention to the power consumption of your connected devices (e.g. disc grinders).**
- If the thermal protection fuse interrupts the power supply to the head catching or the front leg winches, the head catching can still be opened or the front leg winches can still be lowered. After waiting for approx. 3 to 5 minutes, all motors can be operated again in both directions.
- Visually inspect the electrical equipment for damage.
- Check whether the electrical inspection is within the annual interval. (annual inspection of the electrical installation by an expert is required).



- Check the work area and ensure no other unauthorised persons are present. This particularly applies to children.



- Use suitable personal protective equipment.

3.3 Operating the hoof trimming chute

i

For subsequent numbering see device overview(s)

- 1) Place the hoof trimming chute on a level, easily accessible place with a non-slip floor. For freestall barn animals, the use of pushing gates is highly recommended!
- 2) All parts protruding into the chute must be swung or cleared out of the inner area. The rear hind leg retention bracket (2) must be swung up and the belly strap (14) must rest on the rubber mat at the bottom. For variants Basic and Comfort, hook the side barrier chain tightly to the side of the head catching doors (13).
- 3) Release the emergency stop switch on the head catch control (3).
- 4) Check whether the direction of rotation of the front leg winch (17) is correct (arrows on the button indicate the direction of correct rotation). If this is not the case, correct the direction of rotation by switching the phase inverter at the power connection (18).
- 5) Bring the head catch in catching position (head catching doors and frame parallel to the ground) using the "Auf" (Open) and "Zu" (Close) buttons on the head catch control (3).
- 6) Drive the cattle in the chute, preferred using pushing gates.
- 7) Close the head catch with the "Zu" (Close) button on the head catch control (black button (3)), the head catch stops automatically at 160 mm safety width! For animals with a very wide neck, the safety catch must be stopped earlier to avoid squeezing the animal! Additional positioning disc with 210 mm catching width included in delivery! If necessary, have it mounted by competent personnel!

The animal should be as close as possible to the neck frame with its shoulders. Check that the head is securely fixed. Do not squeeze the neck area! If necessary, open the safety catch slightly!

8) Fixing the animal in the chute:

Basic/Comfort:

Place the knee rope (8) horizontally at the height of the knee joint, tighten it as much as possible and fasten it to the bollard clamp (9) according to the sticker.

Professional:

There is no need to put on the knee rope, as the integrated knee chain (8) of the hind leg retention bracket (2) takes over this function.

Pull the lever on the left side of the hind leg retention bracket (2) and swing it to the appropriate working height or push it as far as possible towards the cow. When the lever is released, the hind leg retention bracket locks automatically.

The hind leg retention bracket (2) must be fully locked on both sides!



9) Putting on the securing elements:

Basic/Comfort:

Hang the belly strap (14) on the idler pulley (22), pull the strap tightly by hand through the winding bolt and tighten it with the DS crank (21) 1-2 turns clockwise. This belt prevents the animal from going down in the chute. Do not lift the animal off the ground!

Fasten the rear leg above the hock with the help of the ankle strap (7) and secure it by slightly tightening the rope of the rear leg winch(es) (6). Secure the second rear leg in the variant Comfort as well.

Professional:

Put on the belly strap (14) by pressing the button (9).

As far as the belly strap encloses the animal's chest tightly. This belt prevents the animal from falling to the ground in the chute. Do not lift the animal off the ground!

Fasten both rear legs above the hock with the help of the ankle strap and secure them by slightly tightening the rope of the rear leg winches (6).

10) Lifting a rear leg:

Basic/Comfort:

Swing the hind leg retention bracket down to the appropriate working height and lock the position in the locking rod (5). Lift the rear leg close to the V-Shape. Pay attention to the optimal tension of the knee rope (8)

Professional:

Lift the rear foot close to the V-shape. Pay attention to the optimal tension of the knee chain (8). The tension of the knee chain can be adjusted by hand.

11) Fixing a rear foot.

Place the foot strap (10) above the dewclaw once around the rear foot and hang the end of the foot strap on the holding mushroom on the winding shaft (23). (see picture right side) With the help of a few turns of the DS crank (1) pull the rear foot into the V-shape so that it lies firmly in it.



12) Fixing a front foot:

Attention! Always work on a front foot only when the rear foot is secured on this side!

- Place the front foot strap (4) between the claw and the dewclaw.
- Swing the front foot holder in until the foot is between the two plastic winding bodies. Hook in the small bolt of the foot belt between the plastic winding bodies and wind up the foot electrically ((17) black button). Do not overwind the animal's foot - risk of injury to the animal!
- Swing out the front foot holder (11) until the claw is outside the main frame and thus easily accessible.
- Perform hoof care
- Swing the foot holder back into the frame and then lower the leg. This gives the animal a better balance.
- Press the green button (17) to release and remove the front foot strap (4). Swing out the foot holder completely to the front.

13) After the claw care, loosen all fasteners and securing elements, the head catch at the end!

14) Open the head catch using the green button on the control panel (3).

15) Disc grinders may only be used with protection!

16) It is only allowed to put the disc grinder in the grinder holder on the service arm (19) after the wheel has come to a complete standstill!

17) When the hoof trimming chute is not in operation, the emergency stop switch (red) at the head catch control (3) must be pressed!



All work has to be done sideways, never bend under the body, in front of or behind the feet of the animal!

3.4 Procedure in case of electrical power failure or malfunction



If, during the use of the hoof trimming chute, there is a electrical power failure on the power supply side or a malfunction on the device, so that it is not possible to put down the safety elements and release the animal within a time that is not harmful to the animal, proceed as follows:

NOTE



• Head catch:

To unlock the safety gear, release the spring of the emergency release with the hand wheel and pull the door outwards, thus separating the connection and allowing the safety gear to be opened completely on one side.

If you also want to open the second side, the screw and the bushing on this side must be removed using a suitable tool.

The second side can then also be pulled outwards and the safety gear is completely open.

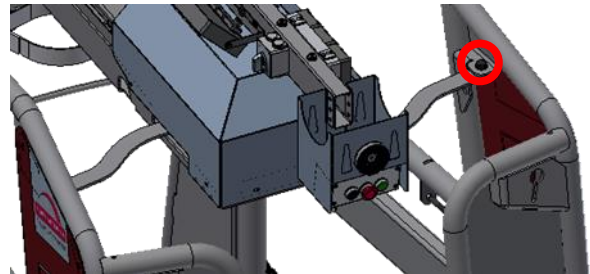

If there is a sudden overload on the safety gear caused by the animal, the integrated overload protection in the emergency release triggers and one side of the safety gear opens.

Figure: Triggered emergency release with integrated overload protection

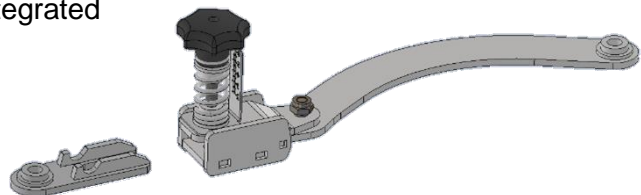

If the emergency release has been triggered, the spring is released by turning the star knob and the sliders can be pushed into each other again. Then retension the spring to the set dimension (55 mm). The setting is selected so that the emergency release is not triggered during normal operation (when opening and closing the interception doors). However, if it is triggered during normal operation, the tension of the spring can be increased by turning the star knob. Only increase the tension minimally, otherwise the gearbox could be damaged!

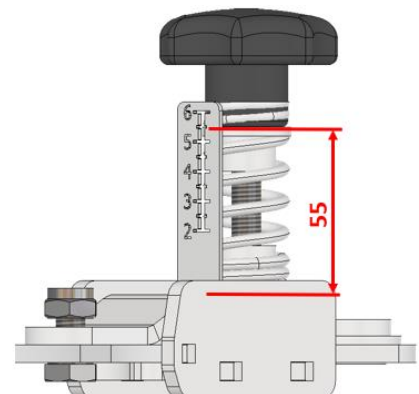

NOTE



• **Front foot winches:**

Remove the screws of the outer plastic winder body and pull the winder body off the shaft.
Remove the front foot strap and free the front foot.



NOTE



• **Rear leg winch:**

If possible, unhook the ankle strap from hook on one side.
In a time-critical emergency, cut the rope.



NOTE



• **Electric belly strap system (Professional):**

If possible, remove the idler pulleys on the left and right of the head catch, unhook the rope and then loosen the link on the chest strap. Caution! Rope may be under tension! In a time-critical emergency, cut the rope.

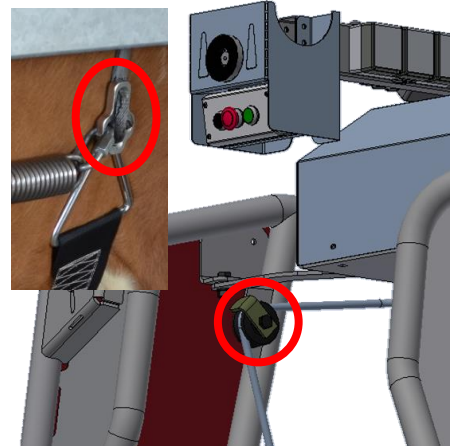

3.5 Animal welfare and natural motion sequences



Take care not to cause pain or injury to the cattle by unnatural movements. This is especially true when lifting the feet and swinging out the front feet.

To make it easier to understand, an overview of the entire musculoskeletal system is included in the operating manual. The most important points are marked (picture below).

The securing elements belly strap and ankle strap serve to secure the animal so that it cannot fall to the ground. Don't let the animal hang in the straps for a long time, as this can cause paralysis with permanent consequences. If the animal gets caught in the harnesses, the work must be interrupted immediately, and the animal must be brought back to its feet by taking appropriate measures. If the animal does not react to this, you must loosen all foot attachments, lower the animal to the ground and, if necessary, open the head catch.

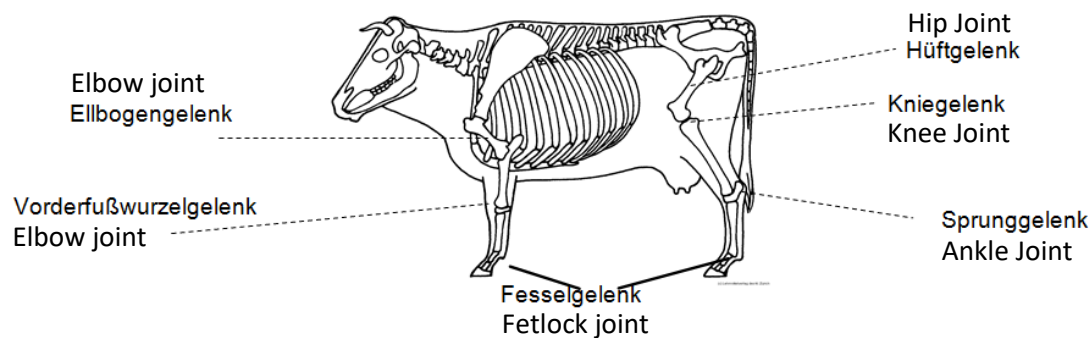

4 Cleaning

NOTE



- Observe the safety instructions in the safety data sheet of the cleaning / disinfecting agents!
- Dispose of cleaning waste water according to the regulation in the country of use!



- Wear safety glasses!



- Do not spray or jet water (high-pressure cleaner) onto electrical components!

5 Maintenance / Servicing / Repair

WARNING



- Maintenance work may only be performed by qualified and trained personnel or by the manufacturer itself.

Maintenance and repair work may only be carried out if suitable lighting is available for the work to be carried out.

DANGER



- Maintenance work may only be carried out when the machine is shut down.

5.1 Electrical danger

DANGER



Contact with energized parts.

Effects of electric current on humans

- Compliance with legal requirements for installation, operation, maintenance and testing of electrical equipment.
- Work may only be carried out by qualified electricians!
- Damaged installations must be repaired immediately by qualified personnel!
- Use of suitable plugs, couplings!
- Recurring tests!
- Before opening electrical equipment housings, it is essential to disconnect them from the power supply and secure them against being switched on again!

The maintenance personnel must be familiar with all technical standards and rules!

5.2 Maintenance and care

The following measures increase the operational reliability and life time of your device:



- All pressure points must be lubricated regularly or after cleaning with a high-pressure cleaner.
- Oil pressure roller safety crank regularly.

Lubrication plan Basic/Comfort:

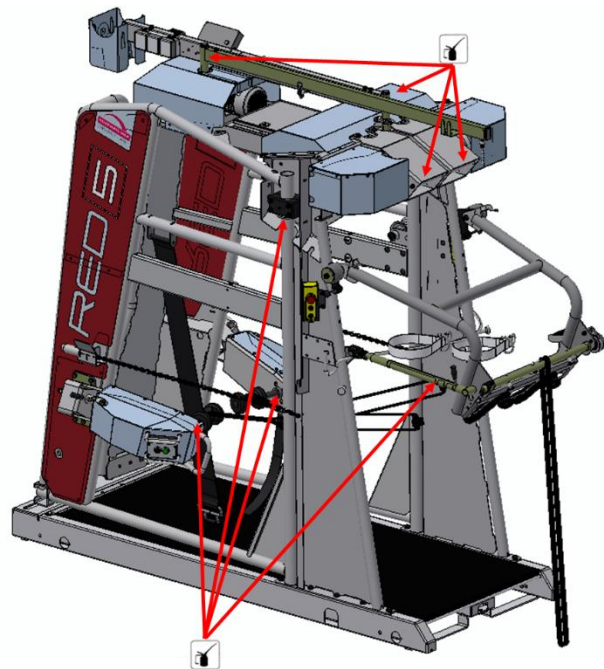
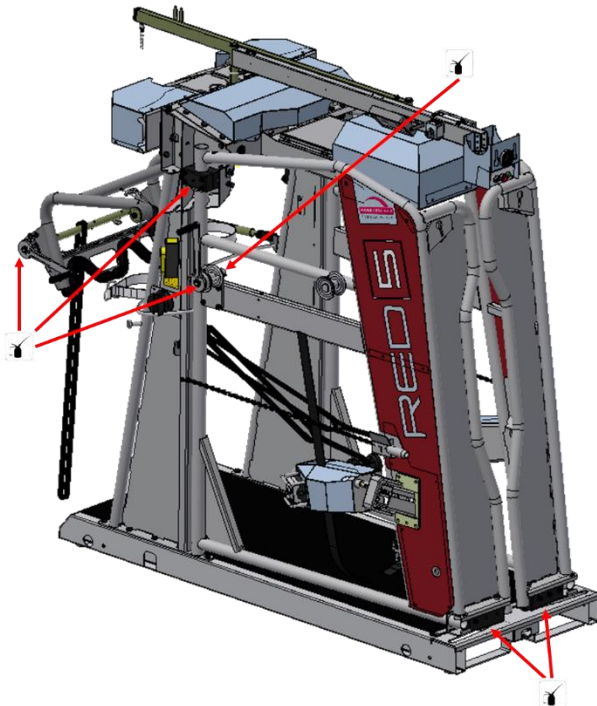

Lubrication plan Professional:

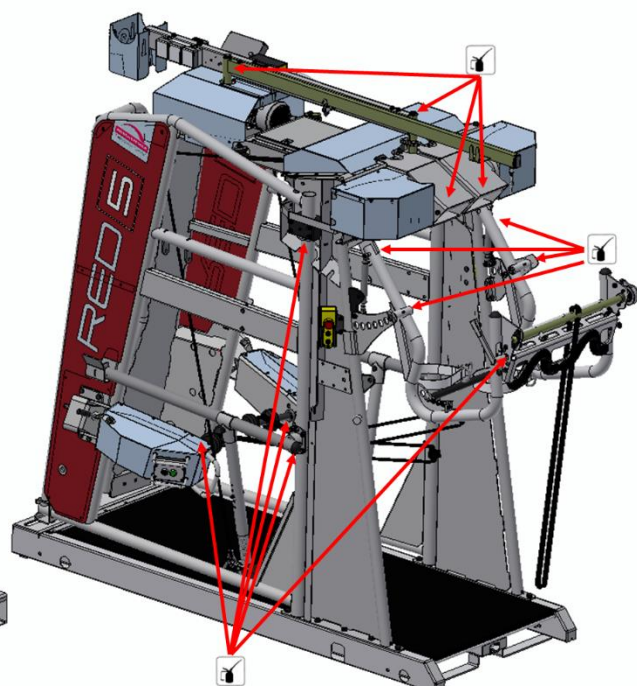
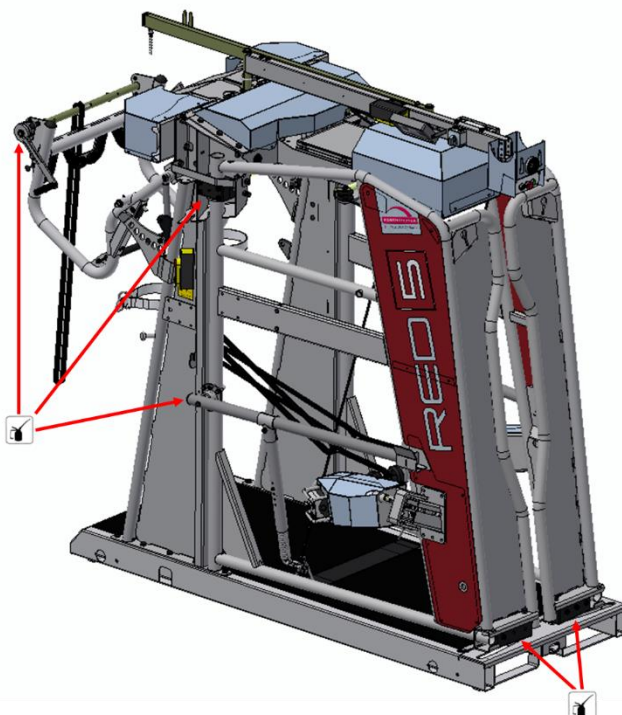

6 Spare Parts



- If a component of the machine has to be replaced, original parts must be used. Spare and wear parts for original components and accessories that are not supplied by the manufacturer of the machine are also not tested and approved by the manufacturer.
- The installation and/or use of such products can, under certain circumstances, change the design properties of the machine and endanger safety.
- The manufacturer accepts no liability for damage or consequential damage resulting from the use of non-original parts and accessories or the improper installation or replacement of original parts and accessories, and the warranty shall become null and void.
- Even after the warranty period has expired, we recommend using original parts to ensure continuous performance of the machine. Contact your local sales and service partner for warranty claims.

7 Periodic inspection

The electrical installation on the machine must be inspected annually by a competent person.

8 Scope of delivery / accessories

Series equipment:

- Complete base frame hot-dip galvanized
- Non-slip rubber floor
- Head catch with electric drive
- Front foot winches electric
- Rear foot lift electric
- Hind leg retention bracket Basic/Comfort with double V-system
- Service arm with LED lighting and disc grinder holder
- Belly strap fixing manually
- Securing elements (knee rope, 2 x front foot belt, foot strap sling, 1 x ankle strap)
- Operating instructions, also on the Internet at www.rosensteiner.at

Item no.:	Type	Description
95 000 B	RED 5 Basic	Serial
95 000 C	RED 5 Comfort	Serial
	Double rear foot lift electrically incl. articulated belt	
95 000 P	RED 5 Professional	Serial
	Double rear foot lift electrically incl. articulated belt	
	Electric belly strap system with integrated barrier	
	Hind leg retention bracket semi-automatic with integrated backstop and double V-system	

Item no.: Accessories

90 171	Manual transport devices consisting of lifting axle + 2 slip-on wheels
90 176	2 pcs. additional wheels for trailer loading with axle
95 016	Basic/Comfort retrofit kit rope for rear shank
95 017	Professional retrofit kit rope for rear shank
95 050	3-point hitch + top-link chain
16 400	Set of guiding fences "hoof trimming comfort"